

MILAM COUNTY COMMISSIONERS COURT

**Henry "Hub" Hubnik
Commissioner, Precinct #1**

**James Denman
Commissioner, Precinct #2**



**Art Neal
Commissioner, Precinct #3**

**Wesley Payne
Commissioner, Precinct #4**

**Bill Whitmire
Milam County Judge
102 S. Fannin Ave.
Cameron, Texas 76520**

**NOTICE OF THE REGULAR MEETING
OF THE
COMMISSIONERS COURT OF MILAM COUNTY, TEXAS**

MONDAY, MARCH 13, 2023, AT 10:00 AM

The Court will convene in person in the Milam County Courtroom, located at the Milam County Courthouse, 102 S. Fannin Ave., Cameron, Texas 76520. If any member of the public would like to speak in person regarding any of the agenda items, please register with the County Judge's Office before 10:00 am, on February 13, 2023.

The following items will be addressed, discussed, considered, passed, or adopted to-wit:

1. A quorum will be established, and the meeting of the Milam County Commissioners Court will be called to order.
2. Invocation.
3. Pledge of Allegiance to the American Flag and the Texas Flag.
4. Consider the minutes from previous commissioner's court meetings and act on any corrections, changes, or approval of any of the said minutes.
5. Comments from the Public (limited to five minutes).
6. Judge's Comments.
7. Review, discuss, and take necessary action to approve the County Treasurer's Report for February as presented by the Milam County Treasurer's Office.
8. Presentation by Serina Cole of the Children's Advocacy Center on the services they provide to Milam County.
9. Discuss and take action on a Variance request for residential subdivision project, 142 Farms from Southwest Engineers.
10. Discuss and take appropriate action on a budget line-item change.

Filed 10th day of March
in 2023, At 2:30P M.

JODI MORGAN
County Clerk, Milam County, Texas
By Jodi Morgan
Deputy

11. Approve HW Lochner, Inc as the construction inspector for the CR 464 bridge replacement/FEMA project PW 5170 – Precinct 4.
12. Grant permission to go out for bids for the Milam County Bank Depository.
13. Discuss Notice of Election-May 6, 2023.
14. Discuss and take action on a Utility Installation request from Bartlett Electric on CR 421. (Exhibit "A").
15. Discuss and take action on a request for approval to waive the weight limit on the Hog Creek Bridge in regard to heavy equipment for use on the Cattlemen 1 Solar Plant.
16. Discuss and take action to approve the Community and Clinical Health Bridge grant MOU with CamRock Clinic, Cameron and Rockdale for the period of Oct 1, 2022 – Sept 30, 2023.
17. Review, discuss, and take necessary action to pay the bills of Milam County, Texas as presented by the County Auditor's Office.
18. Adjourn

Dated this 6th day of March, 2023



Bill Whitmire
Milam County Judge

I, the undersigned County Clerk, do hereby certify that the above notice of the *Regular Meeting* of the Milam County Commissioners Court is a true and correct copy of said Notice. Further, the Notice is published on the Courthouse Door and the County Clerk's Office of Milam County, Texas and at other places readily accessible to the public at all times beginning on the *6th day of March 2023*. The Notice will remain posted continuously for at least 72 hours preceding the scheduled date and time of said court.

County Clerk of Milam County, Texas

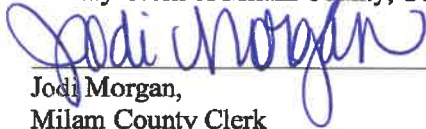

Jodi Morgan,
Milam County Clerk



JODI MORGAN
County Clerk

(This Court reserves the right to convene in executive session at any time deemed necessary for the consideration of confidential matters in accordance with Texas Government code, Chapter 551, Subchapters D and E. Before any closed meeting is convened, the presiding officer will publicly identify the section or sections of the Act authorizing the closed meeting. All final votes or decisions will be taken in open meeting.)

Exhibit A

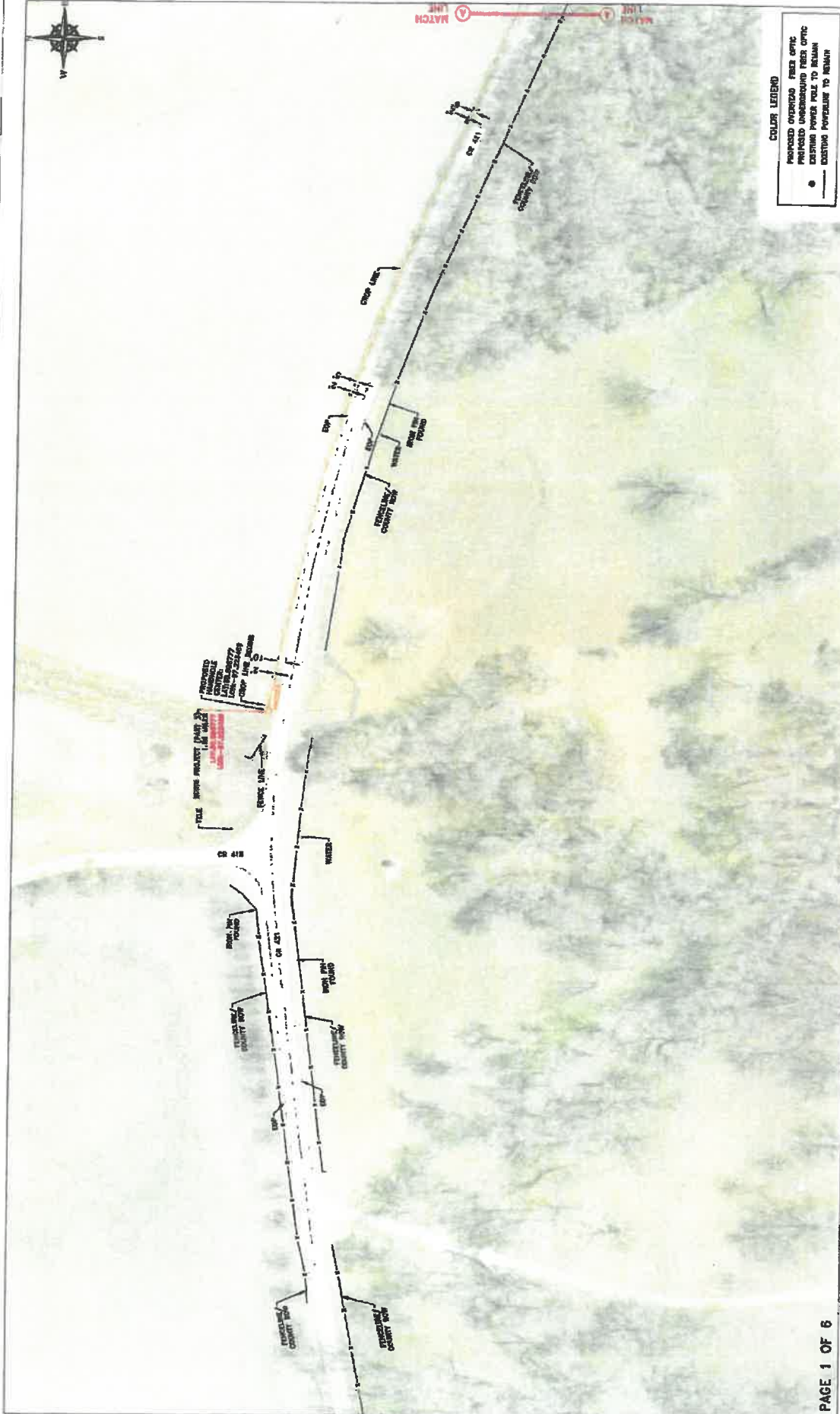

PAGE 1 OF 6

S.E. 20BARTEC003
 BARTLETT FIBER PERMITTING PROJECT
 SUBMITTED BY:
 BARTLETT ELECTRIC COOPERATIVE, INC. (BARTEC)
 PERMIT FOR: CR 421 (SEGMENT 09)

PERMIT DRAWING
 BARTLETT FIBER OPTIC TO BE INSTALLED UNDERGROUND ALONG CR 421
 AS SHOWN. (PART 5)

PROJECT BEGINS APPROXIMATELY 170' FEET EAST OF CR 418 AND ENDS
 APPROXIMATELY 0.10 MILES WEST OF FM 486 IN SAN GABRIEL.

MILAM COUNTY
 THIS DRAWING MAY NOT INCLUDE ALL
 BURIED UTILITIES WITHIN COUNTY ROW.
 ALL DIMENSIONS ROUNDED TO THE
 NEAREST FOOT OR DEGREE

COLOR LEGEND
 PROPOSED OVERHEAD FIBER OPTIC
 PROPOSED UNDERGROUND FIBER OPTIC
 EXISTING POWER POLE TO REMAIN
 EXISTING POLELINE TO REMAIN

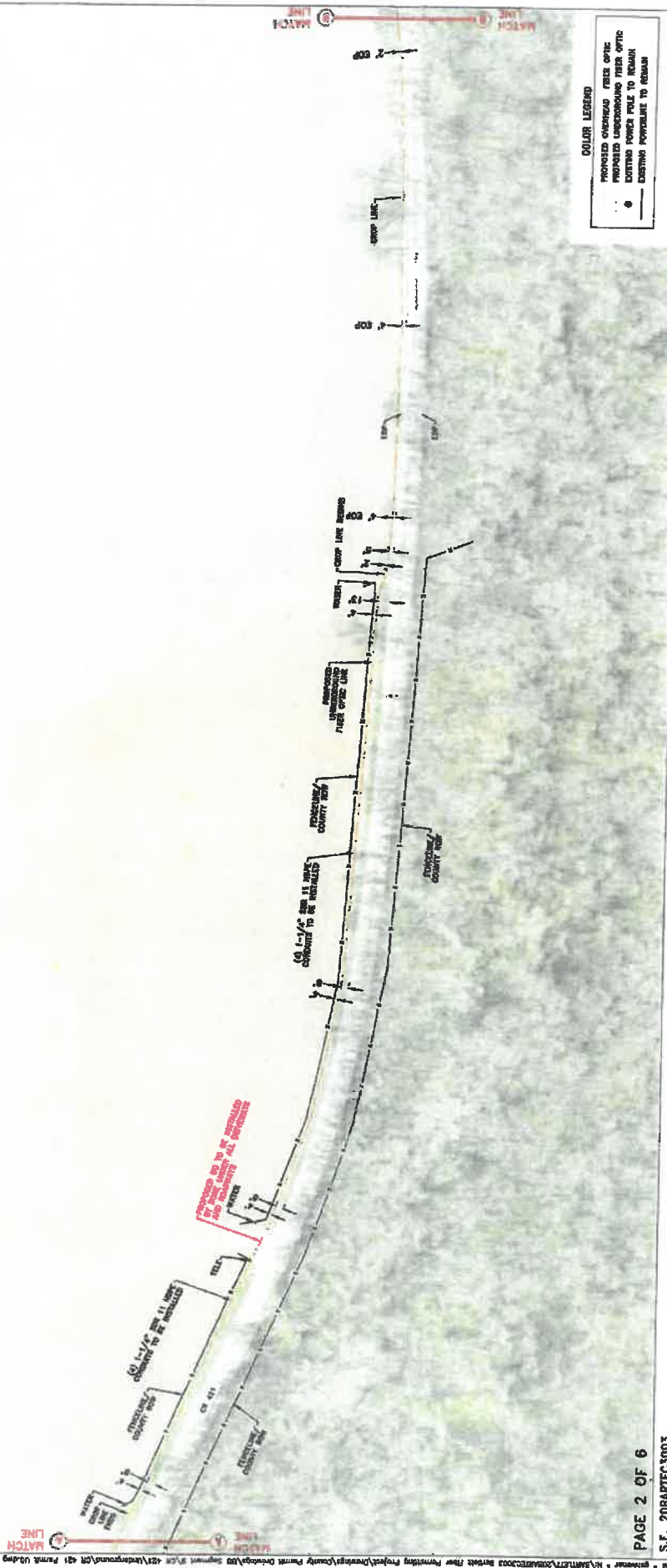

COLOR LEGEND
 PROPOSED UNDERGROUND FIBER OPTIC
 PROPOSED UNDERGROUND FIBER OPTIC BURIED UTILITIES WITHIN COUNTY ROW
 EXISTING POWER POLE TO REMAIN
 EXISTING POWERLINE TO REMAIN

PAGE 2 OF 6

S.F. 202403003
 BARTLETT FIBER PERMITTING PROJECT
 SUBMITTED BY:
 BARTLETT ELECTRIC COOPERATIVE, INC. (BARTEC)
 PERMIT FOR: CR 421 (SEGMENT 08)

PERMIT DRAWING
 BARTLETT FIBER OPTIC TO BE INSTALLED UNDERGROUND ALONG CR 421
 AS SHOWN. (PART 5)

PROJECT BEGINS APPROXIMATELY 170' FEET EAST OF CR 418 AND ENDS
 APPROXIMATELY 0.10 MILES WEST OF FM 486 IN SAN GABRIEL.

MILAM COUNTY
 THIS DRAWING MAY NOT INCLUDE ALL
 BURIED UTILITIES WITHIN COUNTY ROW.
 ALL DIMENSIONS ROUNDED TO THE
 NEAREST FOOT OR DEGREE

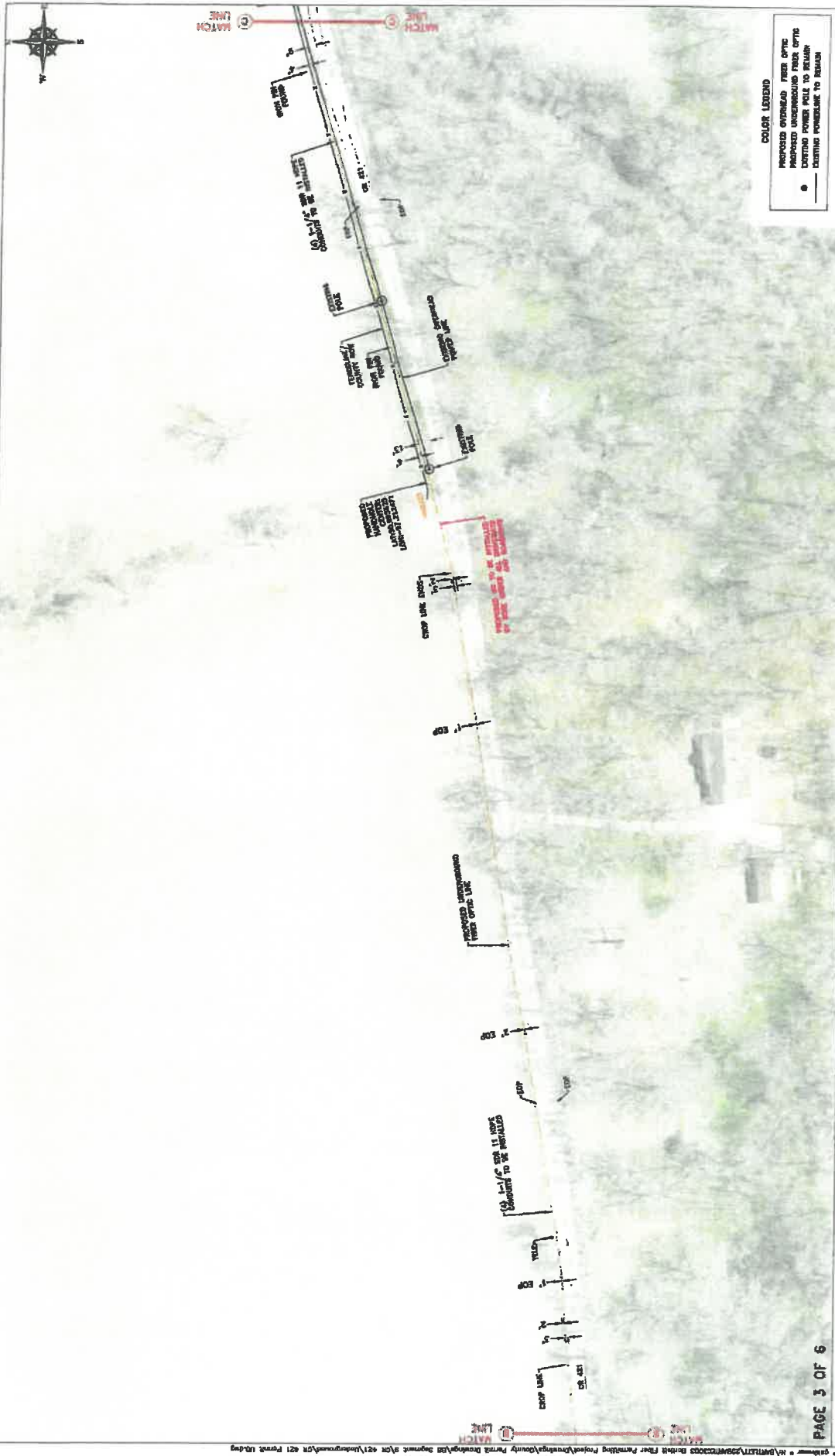

COLOR LEGEND
 PROPOSED UNDERGROUND FIBER OPTIC
 PROPOSED UNDERGROUND FIBER OPTIC
 EXISTING POWER POLE TO REMAIN
 EXISTING POWERLINE TO REMAIN

PAGE 3 OF 6

S.E. 20BARTEC3003
 BARTLETT FIBER PERMITTING PROJECT
 SUBMITTED BY:
 BARTLETT ELECTRIC COOPERATIVE, INC. (BARTEC)
 PERMIT FOR: CR 421 (SEGMENT 05)

PERMIT DRAWING
 BARTLETT FIBER OPTIC TO BE INSTALLED UNDERGROUND ALONG CR 421
 AS SHOWN. (PART 3)
 PROJECT BEGINS APPROXIMATELY 170' FEET EAST OF CR 418, AND ENDS
 APPROXIMATELY 0.10 MILES WEST OF FM 486 IN SAN GABRIEL.

MILAM COUNTY
 THIS DRAWING MAY NOT INCLUDE ALL
 BURIED UTILITIES WITHIN COUNTY ROW.
 ALL DIMENSIONS ROUNDED TO THE
 NEAREST FOOT OR DEGREE

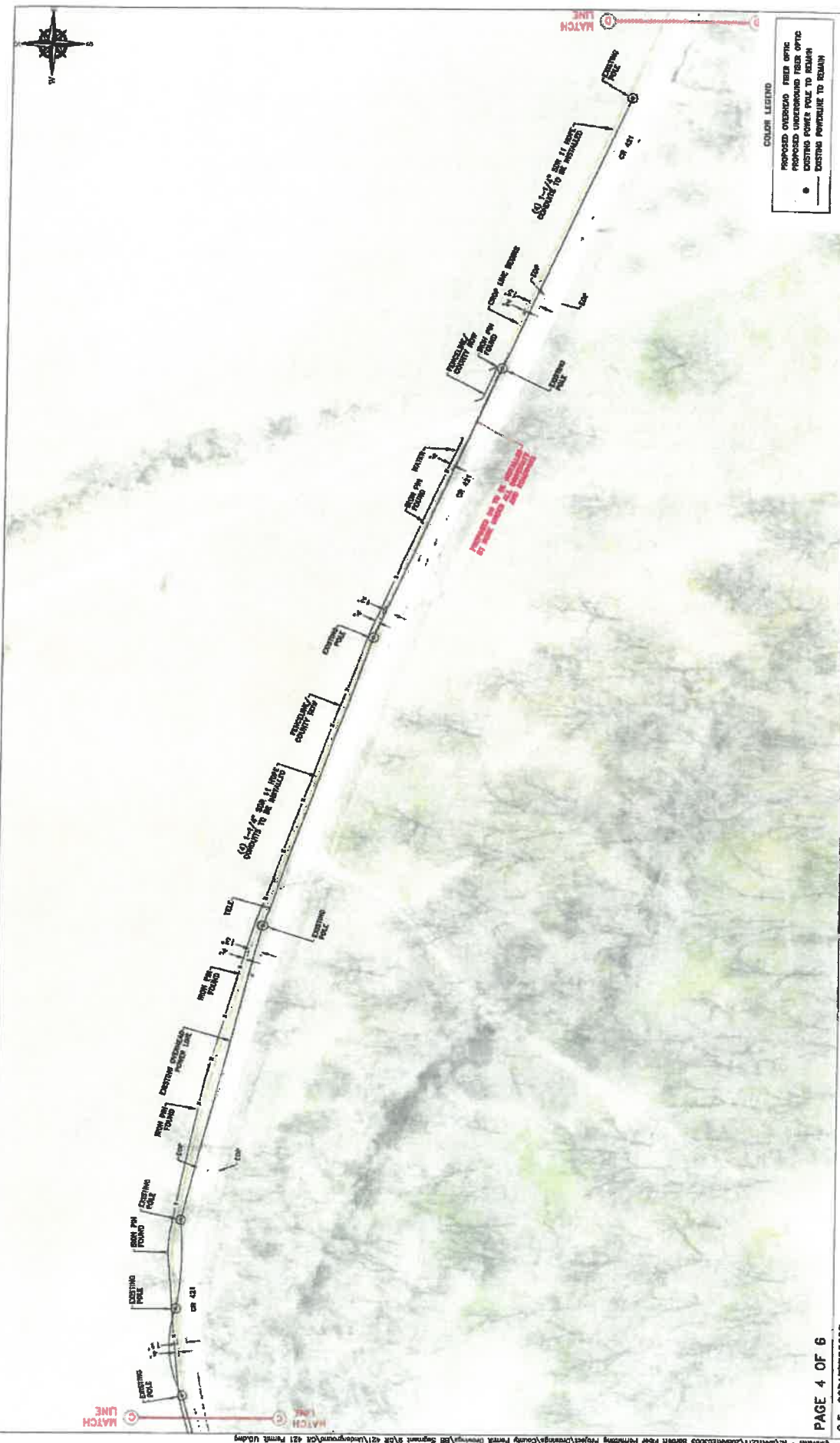

COLOR LEGEND

- PROPOSED OVERGROUND FIBER OPTIC
- PROPOSED UNDERGROUND FIBER OPTIC
- EXISTING POWER POLE TO REMAIN
- EXISTING POWERLINE TO REMAIN

PAGE 4 OF 6
 S.E. 20BARTEC3003
 BARTLETT FIBER PERMITTING PROJECT
 SUBMITTED BY:
 BARTLETT ELECTRIC COOPERATIVE, INC. (BARTEC)
 PERMIT FOR CR 421 (SEGMENT 08)

PERMIT DRAWING
 BARTLETT FIBER OPTIC TO BE INSTALLED UNDERGROUND ALONG CR 421
 AS SHOWN. (PART 3)
 PROJECT BEGINS APPROXIMATELY 170' FEET EAST OF CR 418 AND ENDS
 APPROXIMATELY 0.10 MILES WEST OF FM 488 IN SAN GABRIEL.

MILAM COUNTY
 THIS DRAWING MAY NOT INCLUDE ALL
 BURIED UTILITIES WITHIN COUNTY ROW.
 ALL DIMENSIONS ROUNDED TO THE
 NEAREST FOOT OR DECREE



COLOR LEGEND
 PROPOSED UNDERGROUND FIBER OPTIC
 EXISTING UNDERGROUND FIBER OPTIC
 EXISTING POWER POLE TO REMAIN
 EXISTING POWERLINE TO REMAIN

PAGE 5 OF 6

S.E. 2020ARTEC3003
 BARTLETT FIBER PERMITTING PROJECT
 SUBMITTED BY:
 BARTLETT ELECTRIC COOPERATIVE, INC. (BARTEC)
 PERMIT FOR: CR 421 (SEGMENT 08)

PERMIT DRAWING
 BARTLETT FIBER OPTIC TO BE INSTALLED UNDERGROUND ALONG CR 421
 AS SHOWN. (PART 3)
 PROJECT BEGINS APPROXIMATELY 170' FEET EAST OF CR 418 AND ENDS
 APPROXIMATELY 0.10 MILES WEST OF FM 486 IN SAN GABRIEL.

MILAM COUNTY
 THIS DRAWING MAY NOT INCLUDE ALL
 BURIED UTILITIES WITHIN COUNTY ROW.
 ALL DIMENSIONS ROUNDED TO THE
 NEAREST FOOT OR DEGREE.

